

MAIN FLOOR

~ 2881 SF FINISHED
 ~ 550 SF GARAGE



2363 CAPEWOOD DRIVE
 HUDDLESTON, VA 24104

This drawing represents a reasonable facsimile of the property and should not be interpreted as an architectural rendering. Square footages are approximated.

www.CitySites360.net
sales@citysites360.net



LOWER LEVEL

~ 2345 SF FINISHED



2363 CAPEWOOD DRIVE
HUDDLESTON, VA 24104

This drawing represents a reasonable facsimile of the property and should not be interpreted as an architectural rendering. Square footages are approximated.

www.CitySites360.net
sales@citysites360.net

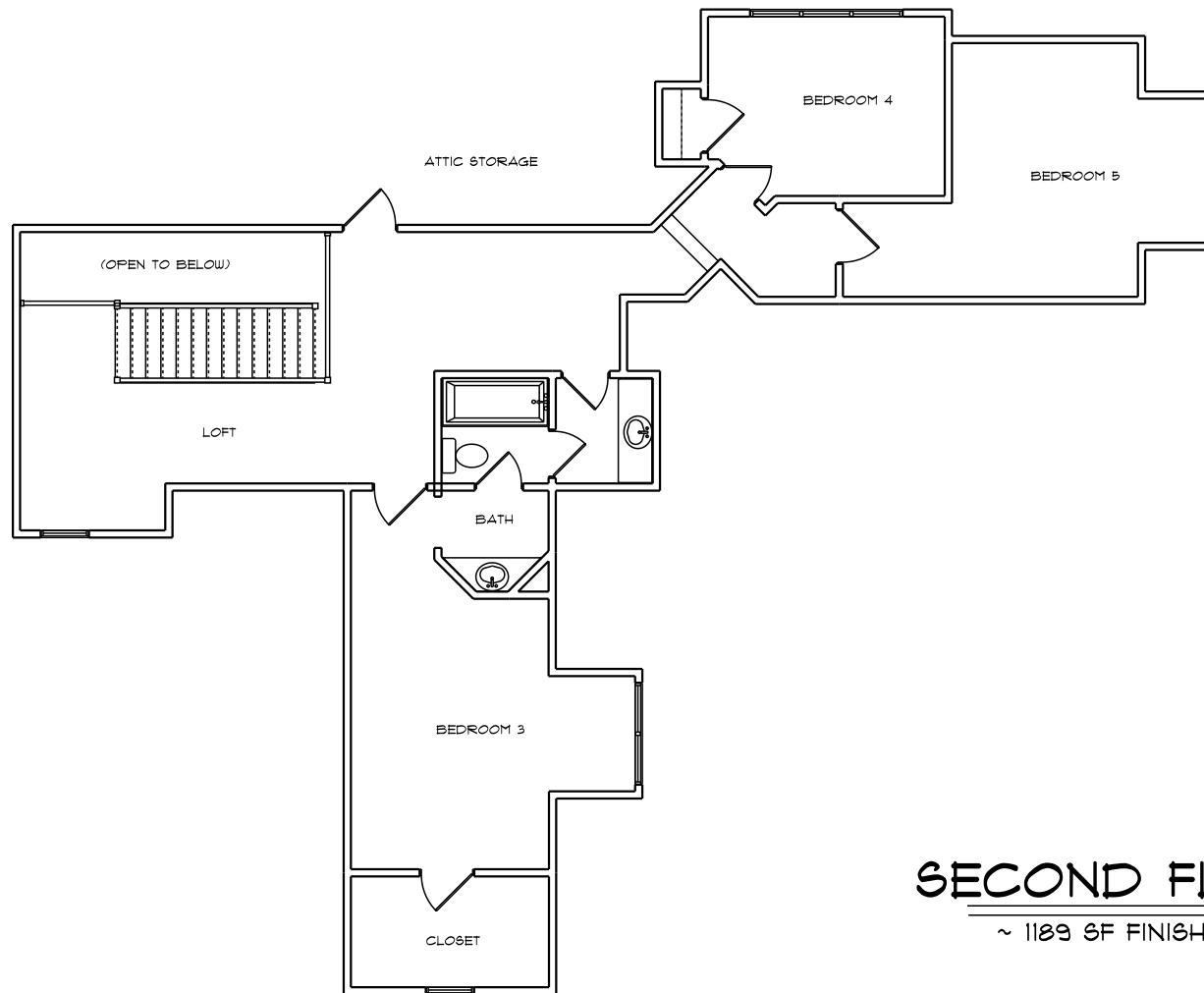

SECOND FLOOR

~ 1189 SF FINISHED



2363 CAPEWOOD DRIVE
HUDDLESTON, VA 24104

This drawing represents a reasonable facsimile of the property and should not be interpreted as an architectural rendering. Square footages are approximated.

www.CitySites360.net
sales@citysites360.net